

Sea-Dog Battery Monitor
Model Number 423112
Assembly and Installation Instructions
Read these instructions completely before starting assembly or installation.

The installation of this panel should be in accordance with the most current revision of U.S. Coast Guard 33 CFR 183-1 and ABYC Standard E-9, Direct Current (DC) Electrical Systems on Boats or E-8, Alternating Current (AC) Electrical Systems on Boats. Standards may be obtained from:

Superintendent of Documents
Government Printing Office
Washington, D.C. 20402

American Boat and Yacht Council
3069 Solomon's Island Road
Edgewater, MD 21037

33CFR 183 Subpart I

Standards and Recommended Practices
For Small Craft

If these standards are unavailable or the installer is otherwise unsure of proper practice, seek competent professional assistance.

EVIDENCE OF FAULTY CONNECTION RESULTING IN COMPONENT DAMAGE WILL VIOLATE WARRANTY PROVISIONS. REVIEW INSTALLATION INSTRUCTIONS BEFORE STARTING INSTALLATION.

INSTALLATION:

Select an area that is as centrally located as possible to the functional operation of the craft and to the craft's battery banks.

DO NOT locate on a bulkhead backing up to a fuel or engine compartment.

DO NOT locate in an exposed area which receives direct water spray. (This principle applies to all electrical equipment).

Normally the panel is mounted on a bulkhead whose rear is accessible for wire installation. Where rear access is not possible, emphasis must be placed upon the use of flexible cables and conductors to permit the panel to be wired from the outside of the bulkhead. (For this you will need four #6 x 3/4" self-tapping screws to mount the panel).

Locate and drill the mounting holes and make the cutout for installation of the panel (see Fig. 1). Then secure the panel in place with four #6-32 x 1-1/4" machine screws and #6-32 hex nuts. When installation is being made in fiberglass, a backup strip of wood should be used.

Connect wire (at least #14) as shown in Fig. 1. If any possibility of personal contact with the rear of the panel exists, provide a suitable cover or enclosure to guarantee safety.

OPERATION:

Your Battery Monitor Panel is supplied with a three position switch. The center position is "OFF". The up position is "TEST BATTERY 1" and the down position is "TEST BATTERY 2".

The switch may be left in either test position to constantly monitor one of the battery banks or it can be left in the off position and then switched to a test position to check the condition of either battery bank.

#D423112

The following is a guide of approximate voltage range interpretations:

Engine not running or running at idle:

12 Volt:	24 Volt:	32 Volt:	
8 - 11	16 - 22	21.3 - 29.3	Very low battery charge
11 - 12	22 - 24	29.3 - 32	Low battery charge
12 - 13	24 - 26	32 - 34.6	Well charged battery

Engine running above idle:

13 - 13.5	26 - 27	33.6 - 36	Low charge rate
13.5 - 15.5	27 - 31	36 - 41	Alternator and voltage regulator OK
15.5 - 16	31 - 32	41 - 48	Voltage regulator out of adjustment

THIS INSTRUCTION AND OPERATION DOCUMENT SHOULD BECOME PART OF THE BOAT OWNERS MANUAL OR SHIP'S PAPERS.

Fig. 1
(Reverse side of panel shown)

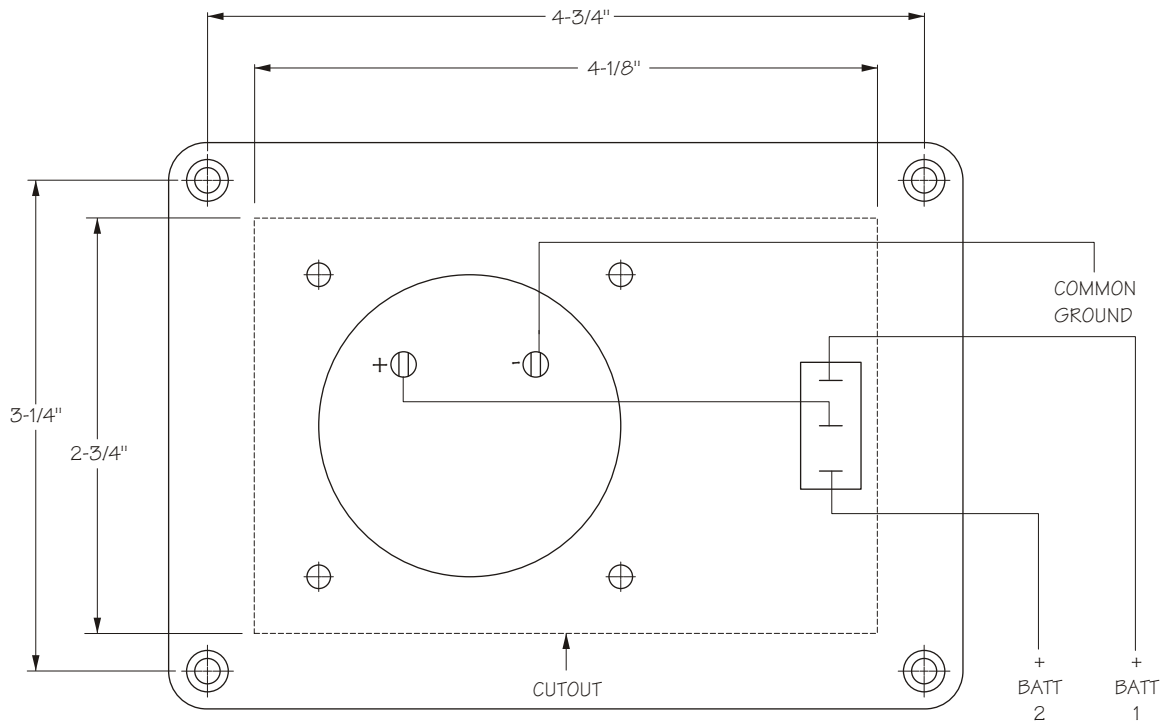

DRILL 5/32" HOLE FOUR (4) PLACES

#D423112